



HARIDHRA ENGINEERS

REPLACEMENT SPARE PARTS FOR
COMPACT SPINNING SYSTEMS





Jet Insert
10845590



Insert Classic
10343145

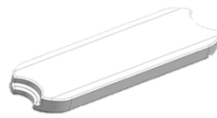

Insert Small
10131885



Closing Nipple
816.2131



Intermediate Gear
10716168



Cradle PK
10595273



Cradle P3-1
10851591



Cradle HP GX
10846431



Cradle HP
10440939



Spacer NT 2.00
lilac 11237219



Spacer NT 2.5
Green 11237307



Spacer NT 2.75
Rose 11237300



Spacer NT 3.00
Red 11237372



Spacer NT 3.25
Orange 11237369



Spacer NT 3.5
Brown 11237377



Spacer NT 3.75
Black 11237690



Spacer NT 4.00
Grey 11237717



Spacer NT 4.5
Beige 11237747

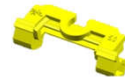

Spacer NT 5.00
Yellow 11237719



Spacer NT 5.5
Blue



Pin NT -0.5
Red 10713145



Pin NT -0.25
Orange 10713144



Pin NT 0.00
Green 10705707

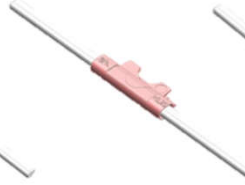

Pin NT +0.25
Pink 10713080

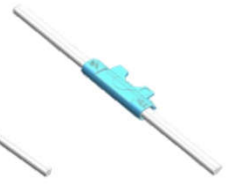

Pin NT +0.5
Blue 10713116



Housing Eli-Top
Flip Type
H1001



Housing Eli-Top
PK Top Arm
H1002



Housing Eli-Top
Classic P3-1
H1003



Flat Spring
Suessen, Kttm
Skf



Spring Clip
10922416

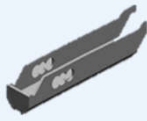

Distributor P3-1
10844310



Take Up Universal
11069256



Take up P3-1
10954642 & 10954625



Saddle Spring
10382131



Rubber Grommet
20.5
10269211



Rubber Grommet
KTTM
10763907



Rubber Grommet
LHS
10981409



Rubber Grommet
RHS
10981412



Condenser
E3
10487780



Cover Condenser
10688476



Single Way condenser
H 1005



Suction Tube
KTTM 47.5
10919000



Suction Tube
KTTM 47.5



Suction Tube
105mm
10679029



Pelican Head
Red 10mm
11018863



Pelican Head
Black 8.5mm
11020589



Nozzle End Piece
11018836



Suction head
5.8mm
10940879



Suction head
6.3mm
10940876



Suessen & Kttm
Top Rollers
Res 17 T 10912023



Suessen & Kttm
top Rollers
Res 22 T 10911988



Eli-Tube Lid R
10928236



Eli-Tube Lid L
10928235



Connecting Piece
10640691



Drive Shaft
10310474



Shaft A
10265797



Shaft BC
10266396



Shaft D
10266391



Shaft Z/S
10266530



Intermediate Piece
RHS ***



Intermediate Piece
LHS ***



Spur Gear 25T
H1006



Spur Gear 28T
H1007



Helical Gear 26 T
10198331



Shaft Coupling D
959.2021



Coupling Bellows
H1008



Coupling
10285230



Helical Gear 115 T
10266050



Tooted Belt Disc
41 T 959.2792



Tooted Belt disc
28 T 959.2793



Roller Disc
10131106



Mag Field Sensor
10289949



Magnetic Ring
10270049



Kit Shaft

Bearing Unit Parts



Bearing Unit RHS
10183502



Bearing Unit LHS
10183503



Drive Shaft 120mm
H1008



Drive Shaft 132mm
H1009



Roller Bearing
22205E1



Helical Gear Z 25
H1010



Helical Gear Z 28
H1011



Needle Roller Bearing
20/32x20-NKI 20/20
H1012



Circlip DIN
471-25x1.2
H1013



Nylor Ring
22205JV
H1013



Washer 1
21.1x29.5x3
H1014



Washer 2
20.1x24x3.5
H1015



Washer 3
8.5x24x3
H1016



Washer 4
24.4x31.8x1.25
H1017



Washer 5
25.1x29.5x7.5
H 1018



Counter Sunk Screw
M8x20-8.8/ A2K
H 1019



Circlip DN
472-52x2
H 1020



Locking Ring
ZV 32x1.2
H 1021



Conic Grease
Nipple AM 6
H 1022

CDS Installation Parts

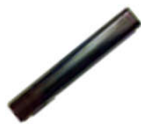

Suction Tube
CDS
10575583



Holding Bow
Bottom
10918238



Fastening Bow
Top
10918233



Retaining Bracket
Suction Tube
10940056



Grommet Bend
10169104



Reducer
H 1023



Tube connection
10649495



Bend 45°x40 mm
10591524



'Y' Distributor
10664206



Grommet Eli-Tube
10731625



Grommet old
10417705



Base plate
10169059



CDS PIPE 160, 200, 250MM
H 1024



Flexible Hose
H 1025



Retaining Bracket CDS
10945587

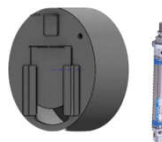

End Cap
160, 200, 250MM



Bellmouth
10755348



Suction Impeller
10755723



Motor Filter Box
H 1026



Frequency Inverter
H 1027



Clamping ring
H 1028



'U' Clamp
H 1029



Filter Box
H 1030



Ventilator Fan
10145747

Drive Strengthening Kit Suitable for Lakshmi Ring Frame



Shaft Coupling



Spur Gear 28T



Spur Gear 25T



Bearing unit



Smart Flex Coupling



Base Plate



Drive Shaft



Inter mediate Piece
RH



Inter mediate Piece
LH



Leveling Bush
For Bearing Unit

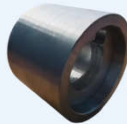

Mounting Of Un Mounting
Gauge For Shaft A



Cam

Pneumatically Operated Dust Eliminating System



End Cap (Muff)
160,200,250,300 mm

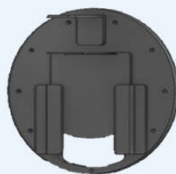

End Cap (Muff)
160,200,250,300 mm



Pneumatic
Piston

Cost Saving up to 50%



- ❖ Normally the bellows & springs will be broken due to heavy compression or fatigue during running
- ❖ We can easily replace bellows and springs alone. No need to change top and bottom collars.
- ❖ We have developed Bellows and spring suitable for Smartflex coupling 25H7/25H7 for compact spinning
- ❖ Bellows and springs offered by us are being manufactured using special alloy steel and heat treated at par with original to ensure uniform and high hardness value

Intermediate Gear



- ❖ We are a company specializing in high precision and long life parts for textile industry.
- ❖ German made polymers are using for our intermediate gears and therefore we provide you with the unexceptionally level of quality.
- ❖ We can offer very attractive prices and short delivery time.
- ❖ Our broad experience in textile processes guarantees you permanent high quality and efficiency in your production

LATTICE APRONS

Lattice Apron Honey Comb



Lattice Apron Regular



Lattice Apron Black Line

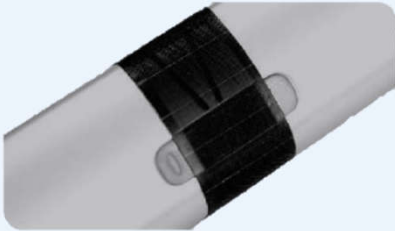

Lattice Apron New Version

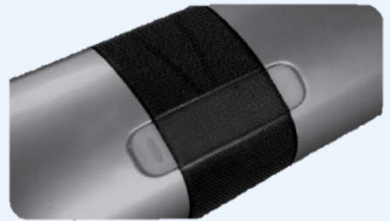

Apron Density	Mesh No {Weft Density/inch}	Mesh No (Mesh/cm ²)	Range of Spinnable Count)	Best Suitable Spinning yarn (Count)
A	150	3500	> 60	80-120
BA	145	3200	40-120	50-80
CA/B	140	3000	32-100	40-80
BC	140	3000	32-100	40-80
C	130	2500	10-80	30-60
CN	100/118	1500/2100	20-100	20-60
CD	100/118	1500/2100	20-100	20-60
D	60/70/80/90	500-1200	Wool	Wool

Apron Size	Suitable for
Φ36.30*25mm {114.00*25mm}	Suessen
Φ41.50*18mm {130.30*18mm}	Spinpact
Φ52.70*18mm {165.50*18mm}	LR J9
Φ30.00*25mm {94.25*25 mm}	Rieter
Φ39.40*25mm {124.00*25mm}	H fang
Φ41.70*25mm {131.00*25mm}	H fang
Φ39.40*17mm {124.00*17mm}	Toyota/KTTM
Φ45.80*20mm {144.00*20mm}	Toyota/KTTM
Φ39.20*25mm {123.00*25mm}	Astrosun
Φ38.50*25mm {121.00*25mm}	Local



HARIDHRA ENGINEERS

1-B,Sridevi Nagar, Ganapathy,
Coimbatore-641006.Tamilnadu.

Techno-Commercial :+91-8778441785

:+91-9655124528

Commercial :+91-9843254528

:+91-9003434302

Office :+91-9047444528

marketing@haridhraengineers.com

tech.haridhra@gmail.com

www.haridhraengineers.com